

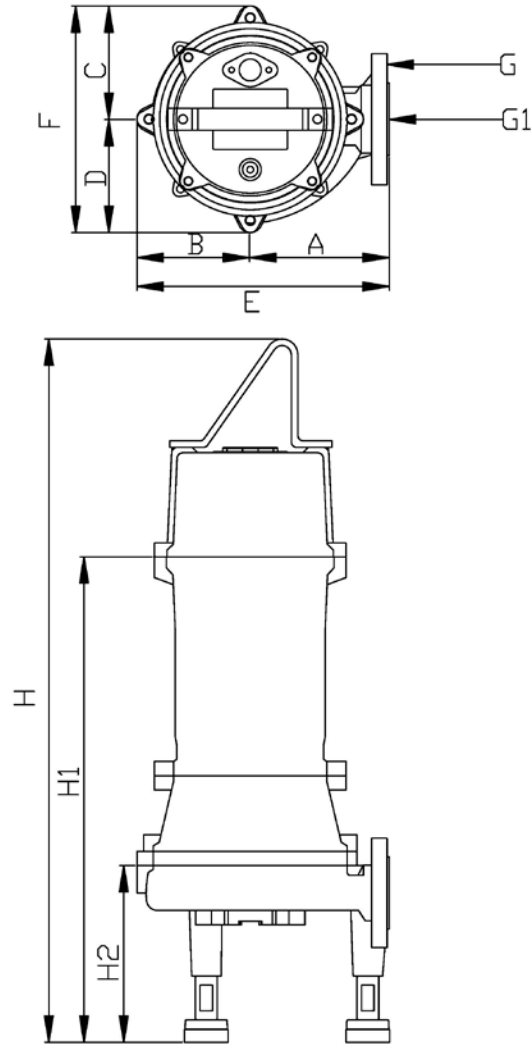

SG-500



Type	A	B	C	D	E	F
Dimensions	6.46"	4.69"	4.92"	4.49"	11.14"	9.41"
Type	G	G1	H	H1	H2	
Dimensions	2" Class# 125lbs F.F.	2" NPT Female	26.34"	20.04"	7.32"	

Specifications subject to change without notice