

STANCOR SUBMERSIBLE WASTEWATER PUMPS

DIMENSIONS

LX SERIES

MODEL LX

80LX, 3 TO 30HP

100LX, 5 TO 30HP

150LX, 7.5 TO 30HP

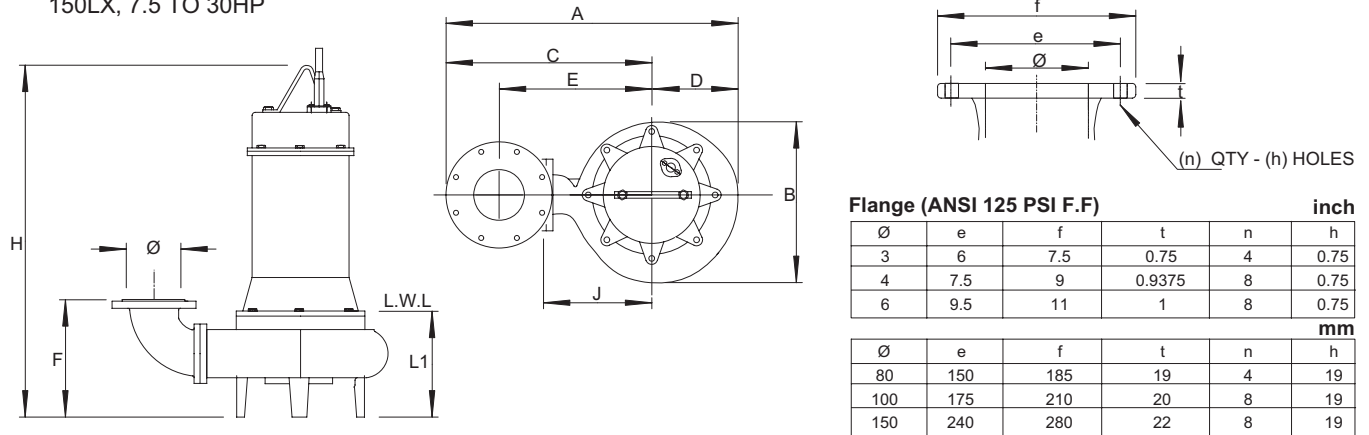

Flange (ANSI 125 PSI F.F)						inch
Ø	e	f	t	n	h	
3	6	7.5	0.75	4	0.75	
4	7.5	9	0.9375	8	0.75	
6	9.5	11	1	8	0.75	

mm						
Ø	e	f	t	n	h	
80	150	185	19	4	19	
100	175	210	20	8	19	
150	240	280	22	8	19	

Dimensions: inch

Phase	Size Ø	Model	Output		Pump & Motor								Weight LB	
			kW	HP	A	B	C	D	E	F	H	J		L1
Three	3	80LX62.2	2.2	3	21	12.625	14.875	6.1875	11.25	11.75	26.3125	8.25	11	176
		80LX63.7	3.7	5	21	12.625	14.875	6.1875	11.25	11.75	28.625	8.25	11	192
		80LX65.5	5.5	7.5	25.1875	15	17.8125	7.375	14.1875	13.125	32.4375	10.0625	12.1875	260
		80LX67.5	7.5	10	25.1875	15	17.8125	7.375	14.1875	13.125	32.4375	10.0625	12.1875	271
		80LX611	11	15	28.875	17.9375	20.1825	8.6875	15.5625	13.75	36.9375	12.375	12.9375	346
		80LX615	15	20	28.875	17.9375	20.1825	8.6875	15.5625	13.75	36.9375	12.375	12.9375	359
	4	80LX622	22	30	30.5625	19.5625	21	9.625	17.3125	14.3125	40.1875	13.375	13.0625	492
		100LX63.7	3.7	5	22.6875	12.625	16.5625	6.1875	12.375	12.3125	28.625	8.25	11	169
		100LX65.5	5.5	7.5	25.6875	15	18.3125	7.375	14.1875	13.125	32.4375	10.0625	12.1875	267
		100LX67.5	7.5	10	25.6875	15	18.3125	7.375	14.1875	13.125	32.4375	10.0625	12.1875	276
		100LX611	11	15	29.375	17.9375	20.6875	8.6875	16.5625	13.75	36.9375	12.375	12.9375	353
		100LX615	15	20	29.375	17.9375	20.6875	8.6875	16.5625	13.75	36.9375	12.375	12.9375	366
	6	100LX622	22	30	31.125	19.5625	21.4375	9.625	17.3125	14.3125	40.1875	13.375	13.0625	498
		150LX65.5	5.5	7.5	28.125	15	20.6875	7.375	15.1875	14.5	32.4375	10.0625	12.1875	280
		150LX67.5	7.5	10	28.125	15	20.6875	7.375	15.1875	14.5	32.4375	10.0625	12.1875	291
		150LX611	11	15	31.75	17.9375	23.0625	8.6875	17.5	15.1875	36.9375	12.375	12.9375	366
		150LX615	15	20	31.75	17.9375	23.0625	8.6875	17.5	15.1875	36.9375	12.375	12.9375	379
		150LX622	22	30	33.4375	19.5625	23.8125	9.625	18.3125	15.6875	40.1875	13.375	13.0625	511

Dimensions: mm

Phase	Size Ø	Model	Output		Pump & Motor								Weight KG	
			kW	HP	A	B	C	D	E	F	H	J		L1
Three	80	80LX62.2	2.2	3	534	320	378	157	285	298	668	210	279	80
		80LX63.7	3.7	5	534	320	378	157	285	298	727	2410	279	87
		80LX65.5	5.5	7.5	640	381	453	188	360	334	824	255	310	118
		80LX67.5	7.5	10	640	381	453	188	360	334	824	255	310	123
		80LX611	11	15	734	455	513	221	420	350	938	315	329	157
		80LX615	15	20	734	455	513	221	420	350	938	315	329	163
	100	80LX622	22	30	777	497	533	245	440	363	1021	335	332	223
		100LX63.7	3.7	5	577	320	420	157	315	313	727	210	279	89
		100LX65.5	5.5	7.5	653	381	465	188	360	334	824	255	310	121
		100LX67.5	7.5	10	653	381	465	188	360	334	824	255	310	125
		100LX611	11	15	746	455	525	221	420	350	938	315	329	160
		100LX615	15	20	746	455	525	221	420	350	938	315	329	166
	150	100LX622	22	30	790	497	545	245	440	363	1021	335	332	226
		150LX65.5	5.5	7.5	713	381	525	188	385	369	824	255	310	127
		150LX67.5	7.5	10	713	381	525	188	385	369	824	255	310	132
		150LX611	11	15	806	455	585	221	445	385	938	315	329	166
		150LX615	15	20	806	455	585	221	445	385	938	315	329	172
		150LX622	22	30	850	497	605	245	465	398	1021	335	332	232